

Planetary Gearboxes PM Series

PM16

This is a group of planetary gearbox or planetary gearhead of PJ series, precision series.

Its diameter is $\varnothing 16$ mm. It has 5 stages, 5 length, and 80 models for your selection.

It is for DC, step or servo motor that the power is less than 3 W. The continuous output torque is 0.13-0.35 Nm.



Table 1: Features

Stages	Length (mm / in.)	Efficiency (%)	Weight (g / oz)
1	14.8 / 0.58	90	15 / 0.40
2	18.4 / 0.72	81	20 / 0.53
3	22.0 / 0.87	73	25 / 0.66
4	25.6 / 1.01	65	30 / 0.79
5	29.2 / 1.15	59	35 / 0.93

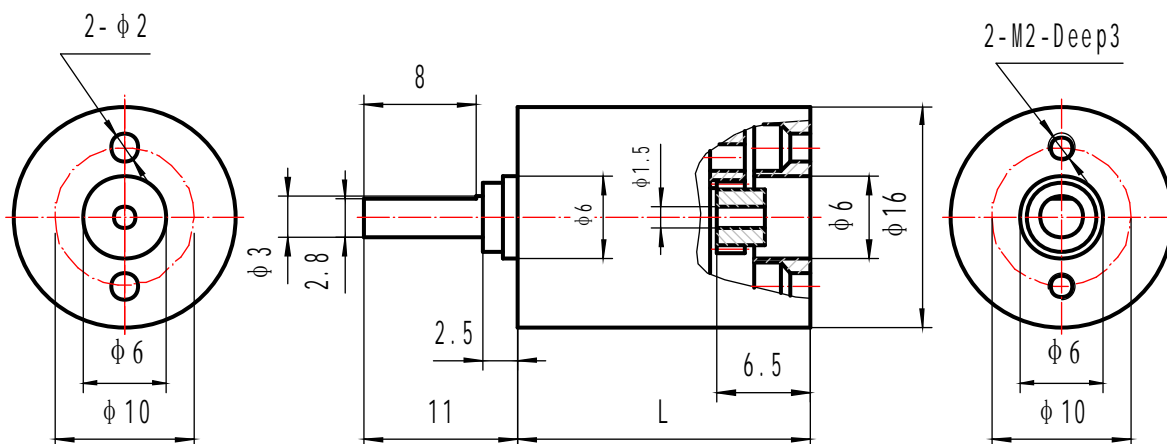

Table 2: Material and load

Items	Description
Shell Material	Carbon steel
Gear Materiel	First stage plastic, rest steel, hard gear surface
Output Shaft Materiel	Carbon steel
Flange Materiel	Aluminum
Bearing on Output End	Sliding bearing
Max. Input Speed	6,000 rpm
Max. Radial Load	8 N
Max. Axial Load	8 N
Max. Install Force	20 N
Radial Clearance	0.1 mm
Axial Clearance	0.2 mm
Operating Temperature	-10 to 85 , (14, to 185°F)

Table 3: Ratio and output torque

Model #	Ratio	Output Torque (Nm)		Stages
		Continuous	Intermittent	
1316001	3.79	0.13	0.17	1
1316002	4.31			
1316003	5.08			
1316004	14.36	0.17	0.2	2
1316005	16.34			
1316006	18.59			
1316007	19.24	0.17	0.2	2
1316008	21.88			
1316009	25.79			
1316010	54.43	0.21	0.3	3
1316011	61.95			
1316012	70.44			
1316013	72.93			
1316014	80.11			
1316015	82.93	0.21	0.3	3
1316016	94.31			
1316017	97.75			
1316018	111.16			
1316019	131.02			

(Continued from Table 3: Ratio and output torque)

Model #	Ratio	Output Torque (Nm)		Stages
		Continuous	Intermittent	
1316020	206.30	0.26	0.34	4
1316021	234.77			
1316022	266.98			
1316023	276.39			
1316024	303.61			
1316025	314.31	0.26	0.34	4
1316026	345.27			
1316027	357.43			
1316028	370.46			
1316029	406.47			
1316030	421.29	0.26	0.34	4
1316031	479.09			
1316032	496.55			
1316033	564.68			
1316034	665.57			
1316035	781.87	0.26	0.34	5
1316036	889.79			
1316037	1011.87			
1316038	1047.51			
1316039	1150.70	0.3	0.38	5
1316040	1191.23			
1316041	1308.58			
1316042	1354.67			
1316043	1404.05			
1316044	1488.12	0.3	0.38	5
1316045	1540.54			
1316046	1596.69			
1316047	1751.90			
1316048	1815.76			
1316049	1881.94	0.3	0.38	5
1316050	2064.89			
1316051	2140.15			
1316052	2433.79			
1316053	2522.50			
1316054	2868.59	0.3	0.38	5
1316055	3381.08			
1316056	2963.29	0.35	0.43	6
1316057	3834.98			

(Continued from Table 3: Ratio and output torque)

Model #	Ratio	Output Torque (Nm)		Stages
		Continuous	Intermittent	
1316058	4361.15	0.35	0.43	6
1316059	4514.76			
1316060	5134.20			
1316061	5321.34	0.35	0.43	6
1316062	5639.98			
1316063	5838.63			
1316064	6051.45			
1316065	6413.80			
1316066	6639.71	0.35	0.43	6
1316067	6881.72			
1316068	7132.56			
1316069	7550.70			
1316070	7825.92			
1316071	8111.17	0.35	0.43	6
1316072	8899.66			
1316073	9224.05			
1316074	9560.27			
1316075	10489.62			
1316076	10871.97	0.35	0.43	6
1316077	12363.64			
1316078	12814.29			
1316079	14572.45			
1316080	17175.89			

For more information about our planetary gearboxes in PJ series, PH series and PM series, please visit our website www.broadwaygear.com. Thanks!