

Planetary Gearboxes PH Series

# PH36

This is a group of planetary gearboxes or planetary gearhead of PH series, commercial series 2.

Its diameter is  $\varnothing 36$  mm. It has 5 stages, 5 length, and 126 models for your selection.

It is for DC, step or servo motor that the power is less than 100W. The continuous output torque is 3-20 Nm.



Table 1: Features

Stages	Length (mm / in.)	Efficiency (%)	Backlash	Weight (g / oz)
1	37.6 / 1.48	90	0.5°	210 / 5.55
2	44.4 / 1.75	83	1.0°	245 / 6.48
3	51.2 / 2.02	77	1.2°	280 / 7.40
4	58.0 / 2.28	72	1.5°	315 / 8.33
5	64.8 / 2.55	67	1.5°	350 / 9.25

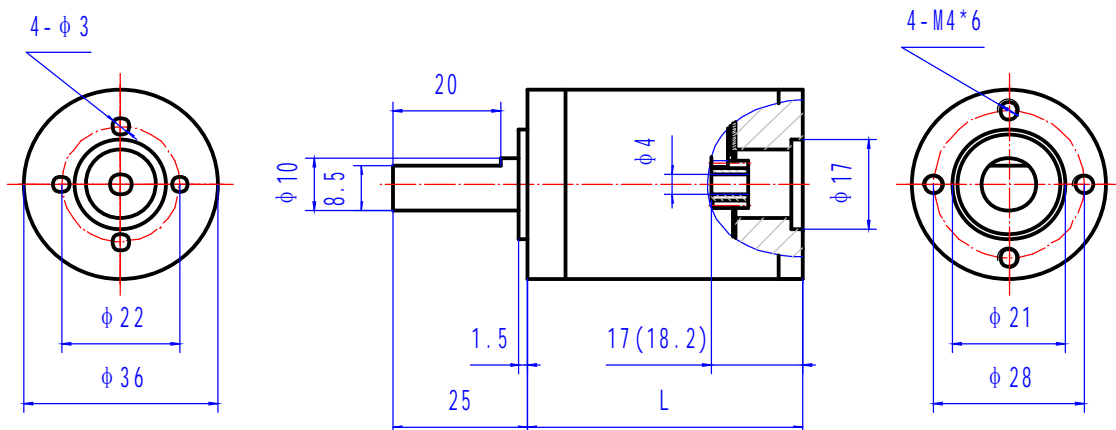

This is for the diameter of output shaft less than 4 mm. If the diameter is more

than 4 mm, the length of the shaft will be recalculated.

Table 2: Material and load

Items	Description
Shell Material	Stainless steel
Gear Material	Steel, hard gear surface*
Output Shaft Material	Stainless steel
Flange Material	Aluminum
Bearing on Output End	Rolling bearing
Max. Input Speed	5,500 rpm
Max. Radial Load	500 N
Max. Axial Load	100 N
Max. Install Force	220 N
Radial Clearance	0.02 mm
Axial Clearance	0.02 mm
Operating Temperature	-40 to 125 °C, (-40, to 257°F) -10 to 85 °C, (-14 to 185°F) for nylon gears

\*-- Optional of nylon or steel gear for first stage

Table 3: Ratio and output torque

Model #	Ratio	Output Torque (Nm)		Stages
		Continuous	Intermittent	
1236001	3.50	3	5	1
1236002	4.00			
1236003	4.75			
1236004	6.00			
1236005	12.25	8	12	2
1236006	14.00			
1236007	16.00			
1236008	16.63			
1236009	19.00			
1236010	21.00	8	12	2
1236011	22.56			
1236012	24.00			
1236013	28.50			
1236014	36.00	6	8	3
1236015	42.88	18	25	
1236016	49.00			
1236017	56.00			
1236018	58.19			
1236019	64.00			

(Continued from Table 3: Ratio and output torque)

Model #	Ratio	Output Torque (Nm)		Stages
		Continuous	Intermittent	
1236020	66.50	18	25	3
1236021	73.50			
1236022	76.00			
1236023	78.97			
1236024	84.00			
1236025	90.25	18	25	3
1236026	96.00			
1236027	99.75			
1236028	107.17			
1236029	114.00	10	12	
		16	25	
1236030	126.00	10	12	3
1236031	135.38			
1236032	144.00			
1236033	171.00			
1236034	216.00			
1236035	150.06	6	8	4
1236036	171.50			
1236037	196.00			
1236038	203.66			
1236039	224.00	18	25	4
1236040	232.75			
1236041	256.00			
1236042	257.25			
1236043	266.00			
1236044	276.39	20	30	4
1236045	294.00			
1236046	304.00			
1236047	315.88			
1236048	336.00			
1236049	349.13	20	30	4
1236050	361.00			
1236051	375.10			
1236052	384.00			
1236053	399.00			
1236054	428.69	20	30	4
1236055	441.00			
1236056	456.00			
1236057	473.81			
1236058	504.00			

(Continued from Table 3: Ratio and output torque)

Model #	Ratio	Output Torque (Nm)		Stages
		Continuous	Intermittent	
1236059	509.07	10	12	4
1236060	541.50	20	30	
1236061	576.00			
1236062	598.50			
1236063	643.03	10	12	4
1236064	684.00	20	30	
1236065	756.00	10	12	
1236066	812.25			
1236067	864.00			
1236068	1026.00	6	8	4
1236069	1296.00			
1236070	525.22	20	30	5
1236071	600.25			
1236072	686.00			
1236073	712.80			
1236074	784.00	20	30	5
1236075	814.63			
1236076	896.00			
1236077	900.38			
1236078	931.00			
1236079	967.37	20	30	5
1236080	1024.00			
1236081	1029.00			
1236082	1064.00			
1236083	1105.56			
1236084	1176.00	20	30	5
1236085	1216.00			
1236086	1221.94			
1236087	1263.50			
1236088	1312.86			
1236089	1344.00	20	30	5
1236090	1396.50			
1236091	1444.00			
1236092	1500.41			
1236093	1536.00			
1236094	1543.50	20	30	5
1236095	1596.00			
1236096	1658.34			

(Continued from Table 3: Ratio and output torque)

Model #	Ratio	Output Torque (Nm)		Stages
		Continuous	Intermittent	
1236097	1714.75	20	30	5
1236098	1764.00			
1236099	1781.73	20	30	5
1236100	1824.00			
1236101	1895.25			
1236102	2016.00			
1236103	2036.27			
1236104	2094.75	20	30	5
1236105	2166.00			
1236106	2250.61			
1236107	2304.00			
1236108	2394.00			
1236109	2418.07	10	12	5
1236110	2572.13	20	30	
1236111	2646.00			
1236112	2736.00			
1236113	2842.88			
1236114	3024.00	20	30	5
1236115	3054.40	10	12	
1236116	3249.00	20	30	
1236117	3456.00			
1236118	3591.00			
1236119	3858.19	10	12	5
1236120	4104.00	20	30	
1236121	4536.00	10	12	
1236122	4873.50			
1236123	5184.00			
1236124	6156.00	10	12	5
1236125	7776.00	8	10	

The output shaft length of motor in blue model number depends on the diameter of the output shaft.  
 Please notice us when you put purchase order.

For more information about our planetary gearboxes in PJ series, PH series and PM series,  
 please visit our website [www.broadwaygear.com](http://www.broadwaygear.com). Thanks!