

Planetary Gearboxes PH Series

PH20

This is a group of planetary gearboxes or gearheads of PH series, commercial series 2.

Its diameter is Ø20 mm. It has 5 stages, 5 length, and 20 models for your selection.

It is for DC, step or servo motor its power is less than 10W. The continuous output torque is 0.5-1.2 Nm.



Table 1: Features

Stages	Length (mm / in.)	Efficiency (%)	Backlash	Weight (g / oz)
1	20.3 / 0.80	90	≤1.2°	30 / 0.79
2	24.1 / 0.95	81	≤1.5°	35 / 0.93
3	27.8 / 1.09	73	≤1.8°	46 / 1.22
4	31.7 / 1.25	65	≤1.8°	55 / 1.45
5	35.5 / 1.40	59	≤1.8°	65 / 1.72

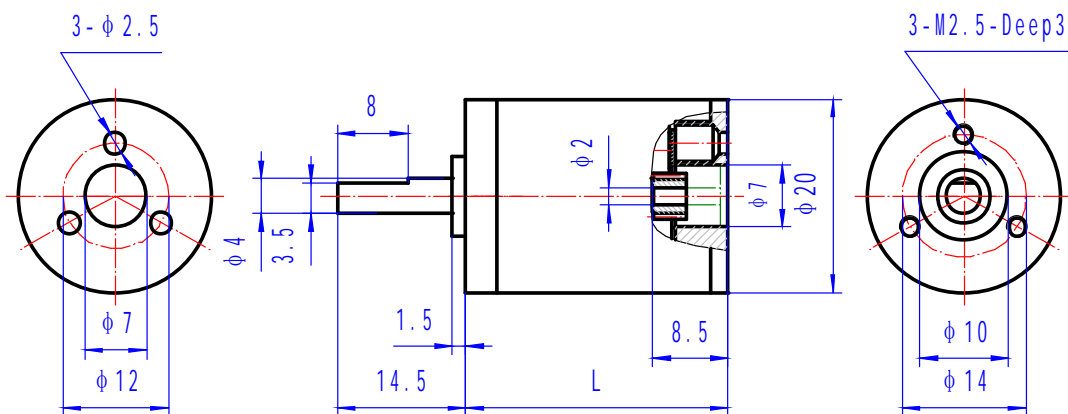

Table 2: Material and load

Items	Description
Shell Material	Stainless steel
Gear Materiel	Steel, hard gear surface*
Output Shaft Materiel	Stainless steel
Flange Materiel	Aluminum
Bearing on Output End	Rolling bearing
Max. Input Speed	6,000 rpm
Max. Radial Load	20N
Max. Axial Load	20N
Max. Install Force	100N
Radial Clearance	0.04mm
Axial Clearance	0.04mm
Operating Temperature	-40,to 125 , (-40, to 257°F) -10 to 85 , (-14 to 185°F) for plastic gears

*-- Optional of plastic or steel gear for first stage

Table 3: Ratio and output torque

Model #	Ratio	Output Torque (Nm)		Stages
		Continuous	Intermittent	
1220001	3. 57	0. 5	0. 8	1
1220003	4. 60			
1220005	12. 76	0. 5	1	2
1220008	16. 43			
1220011	21. 16			
1220015	45. 55	1. 2	1. 8	3
1220018	58. 67			
1220023	75. 57			
1220028	97. 34			
1220035	162. 69	1. 2	1. 8	4
1220038	209. 55			
1220044	269. 90			
1220051	347. 63			
1220059	447. 75			
1220070	581. 05	1. 2	1. 8	5
1220073	748. 39			
1220079	963. 92			
1220088	1241. 53	1. 2	1. 8	5
1220099	1599. 09			
1220109	2059. 63			

For more information about our planetary gearboxes in PJ series, PH series and PM series, please visit our website www.broadwaygear.com. Thanks!